

MV 302

气动隔膜阀

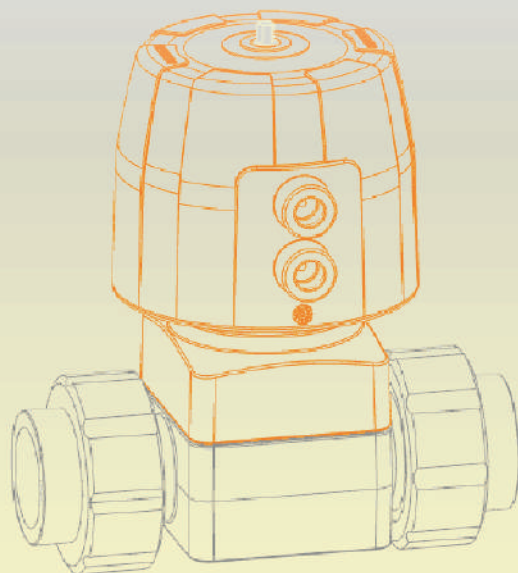

KOSCN Control Valves MV302为紧凑的经济型气动隔膜阀，鸭嘴式曲径流道设计确保最佳的流通能力，隔膜联动机构更加优化。更小的体积和6公斤的压力等级，适合绝大多数设备集成商的低成本应用。

方便操作和维护

- * 执行机构螺纹连接，易拆装
- * 全塑的外观结构，美观且耐腐蚀
- * 优化进气设计，震动小
- * 所有连接形式和国际市场阀门保持一致安装长度
- * 集成可视位置反馈，且易于观察
- * 优越的润滑性能，免维护
- * 进气方向每90°可选转向。利于狭小空间安装

高安全性能

- * 悬挂式避空的隔膜联轴机构，对膜片充分保护
- * 阀体和气动执行器过压余量设计，保证安全性应用
- * 平滑曲径可保证阀门在高流速应用时的有效闭合

高灵活性

- * 双由令连接、承插、对焊
- * 接口标准有公制、日标、美标
- * 膜片EPDM、FPM、EPDM-PTFE
- * 阀体PVC-U、PVC-C、PP-H、PP-Natural、PVDF
- * 部分产品有禁油选择

最佳流通性能

- * 良好的线性流体特性可以实现调节功能
- * 平滑过度的曲径流道，实现比传统隔膜阀的双倍流通能力
- * 适合含有少量颗粒和固体的介质

应用

- * 垃圾渗透液
- * 光伏
- * 集成电路板
- * 电镀
- * 玻璃面板
- * 电子半导体
- * 造纸
- * 生物制药
- * 食品饮料
- * 纺织
- * 印染



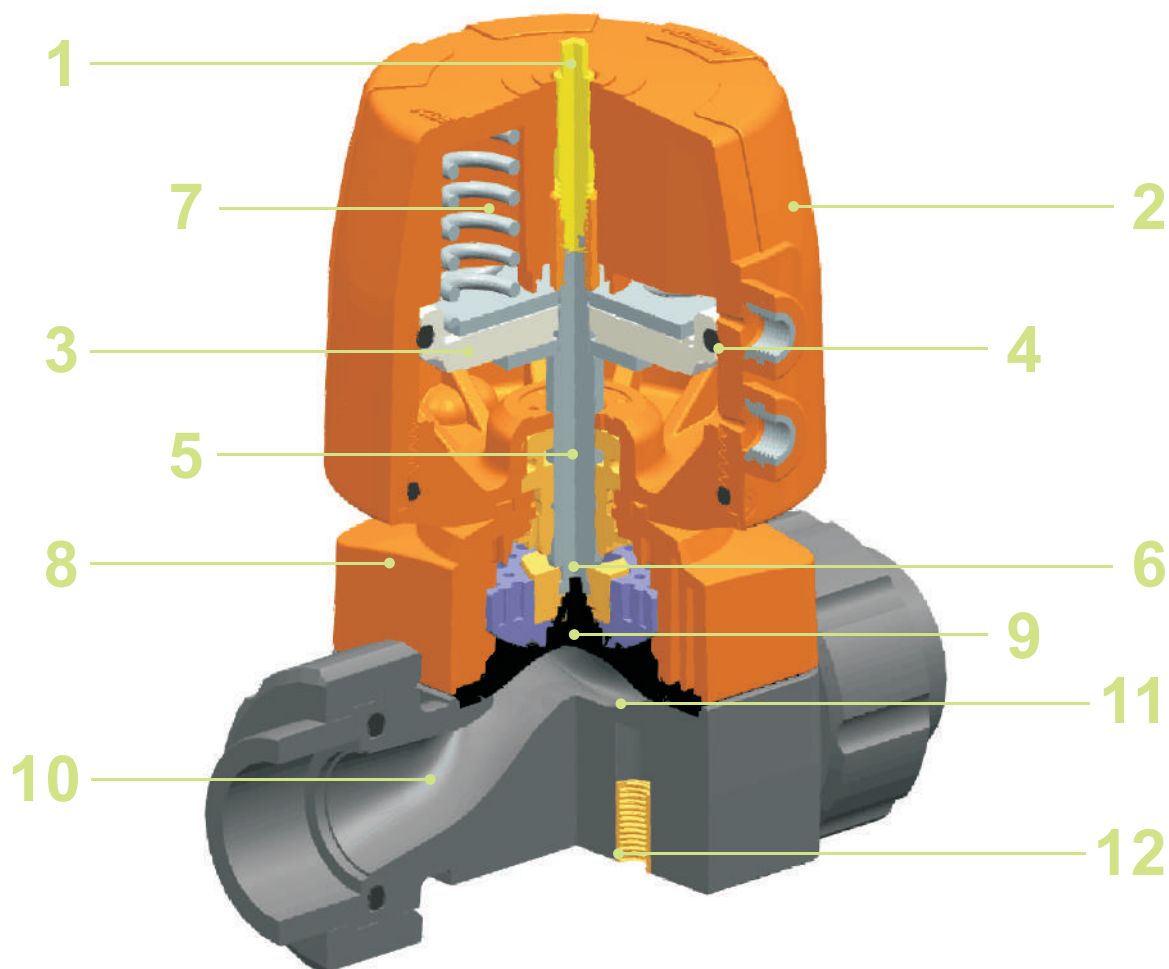

1 明亮色的位置指示器，阀位指示易于观察。

2 气动执行机构，轻便紧凑，适用于化学腐蚀性环境下的重型应用，并采取过压余量设计，安全可靠。

3 高强度的玻纤塑料活塞，组合不锈钢支撑板保证无型变，实现高精度的滑动密封性能，保证了长时间的工作寿命，不需要任何维护。

4 自润滑的活塞环配合0度的气缸壁，耦合压力均衡，气密性效果优越。

5 高强度不锈钢阀杆，且独特的材质性能，完全不会和润滑脂反应。

6 独立悬挂式的联轴器机构，保证阀杆和膜片之间防止集中负载，改善密封并延长其寿命。

7 执行机构配置 3-6 个防腐处理的独立弹簧，将负载均匀分布在活塞上。

8 阀座盖，膜片周边封闭设计，确保橡胶在没有横向膨胀的情况下得到完美的压缩。

9 含有内嵌硫化纤维层增强的模制开状态的隔膜，在温度升高和压力加大时，具有较高的机械性能和稳定性。特制的隔膜螺钉，使和橡胶的结合更加牢固。

10 鸭嘴式流道设计大大增加了流量系数，减少了压降。效率的提高也使阀门在实际应用中的口径缩减，降低成本。

11 独特的平滑曲径也大大改善了其特性曲线，使得在整个开闭行程中都能进行极其灵敏、精确的调整。

12 底座带有标准安装的固定螺栓，应用于管路系统中的独立支撑，可有效减小管路应力。

技术特性

压力温度曲线

数据基于清水类介质及25年的安全寿命；

其他介质的应用必须降低温度和压力。

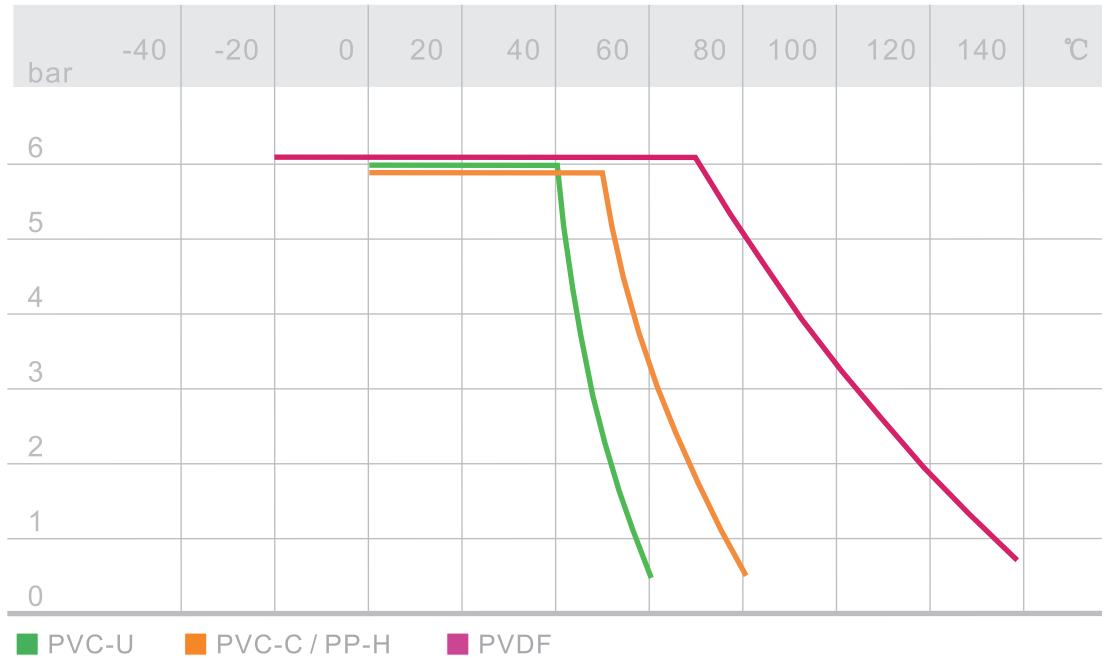

流通能力

基于20°C清水类介质及1bar压差时数据；

$$Cv = kv \times 0,07$$

$$Fv = kv \times 0,0585$$

$$Kv \text{ (l/min)}$$

$$Cv \text{ (gal/min) US}$$

$$Fv \text{ (gal/min) GB}$$

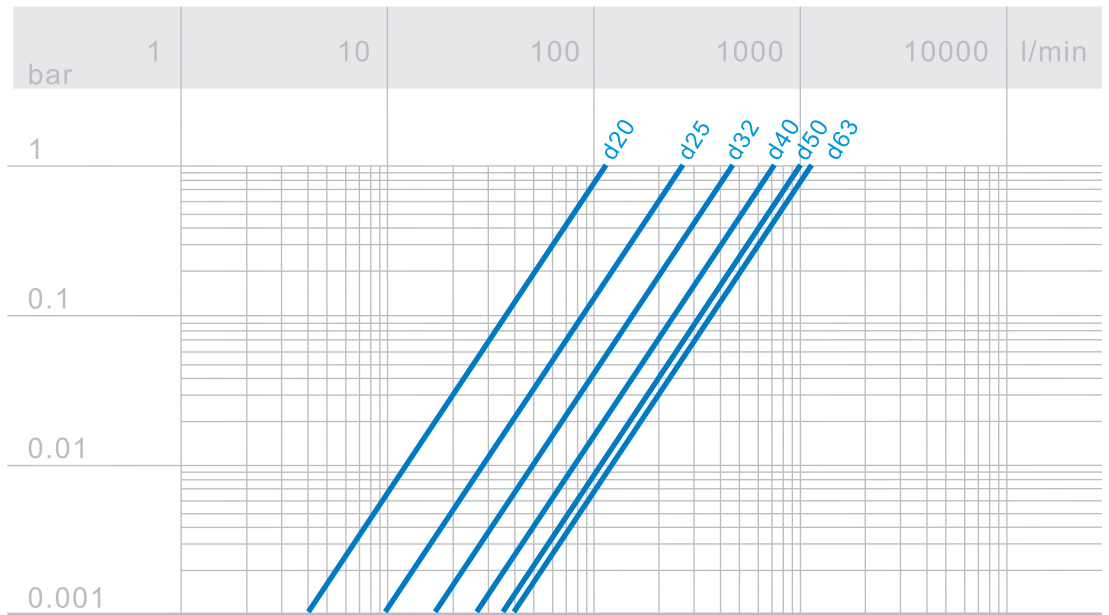

d	20	25	32	40	50	63
Kv100 (l/min)	125	266	527	743	1058	1172

相对流量 线性图

相对流量线性系数是指流量作为阀门开启行程的函数的变化。

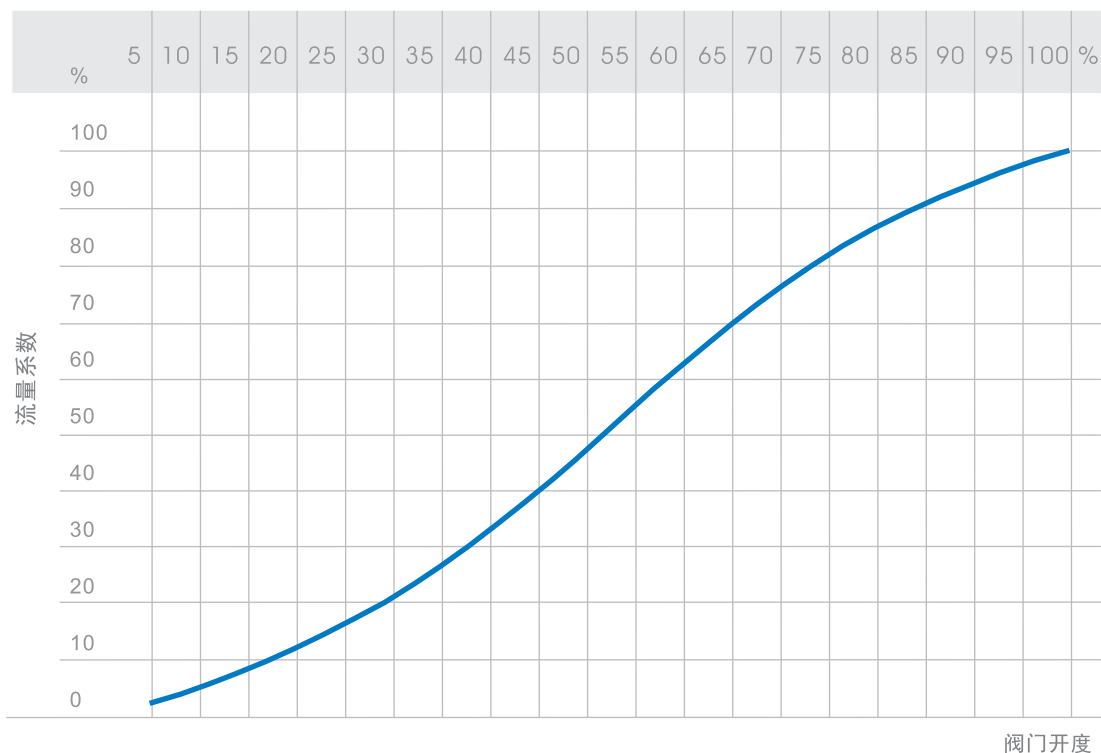

工作压力 控制压力

EPDM, FPM 材质的隔膜
所需最大控制压力

按口径的实际驱动数据
详见维护使用手册

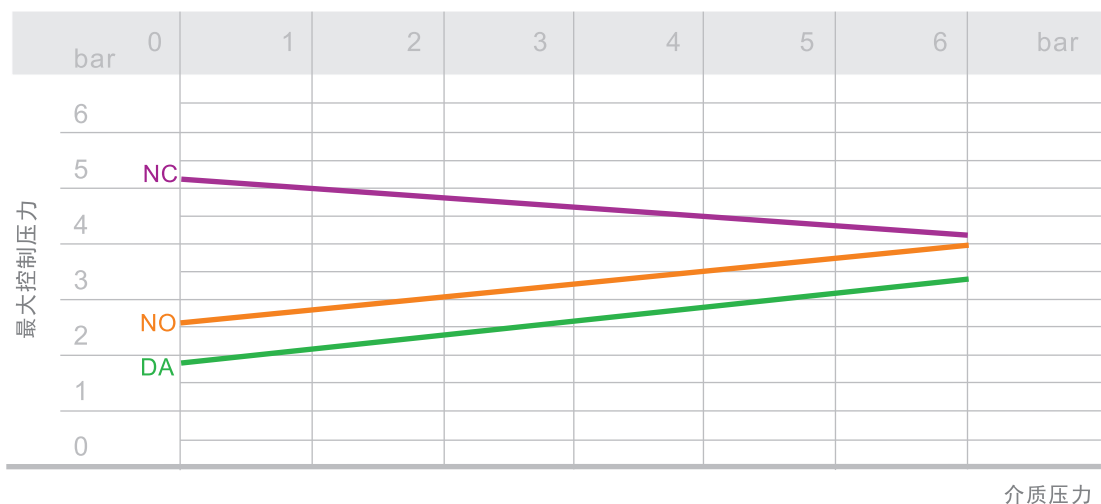

PTFE 材质的隔膜
所需最大控制压力

按口径的实际驱动数据
详见维护使用手册

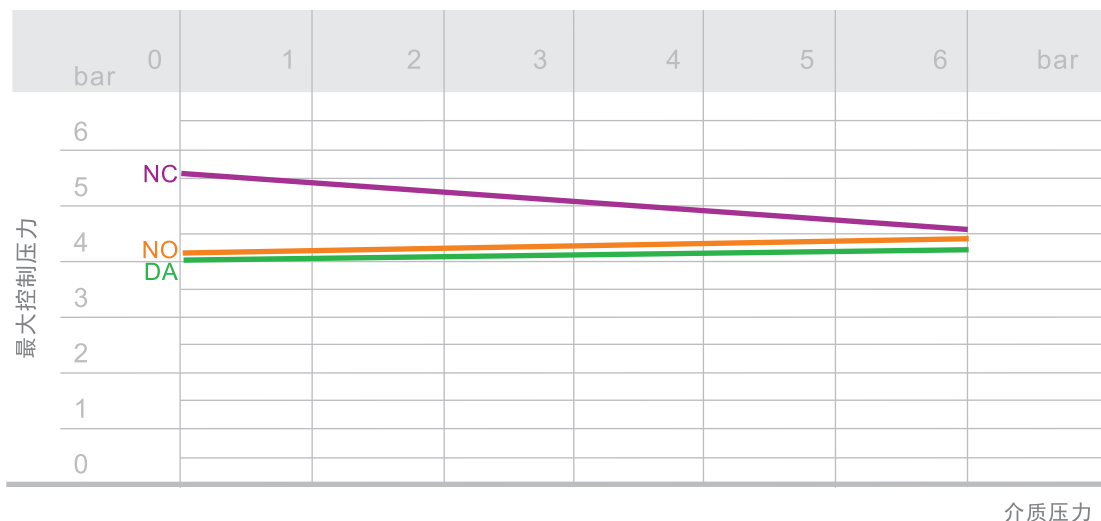

执行机构 功能特征

作用形式	双作用-DA	单作用-SA	
执行器类型	双作用-DA	单作用-NC	单作用-NO
阀门开启	Air	Air	Spring
阀门关闭	Air	Spring	Air

执行机构 耗气量

符合要求的驱动压力下
阀门完全开启或关闭时
所需压缩空气量 dm³

d	20	25	32	40	50	63
NC	0,12	0,12	0,12	0,24	0,24	0,24
NO	0,20	0,20	0,20	0,44	0,44	0,44
DA	开启	0,12	0,12	0,12	0,24	0,24
	关闭	0,20	0,20	0,20	0,44	0,44

压缩空气 连接

执行器类型	双作用-DA	单作用-NC	单作用-NO
阀门开启	B	B	-
阀门关闭	A	-	A

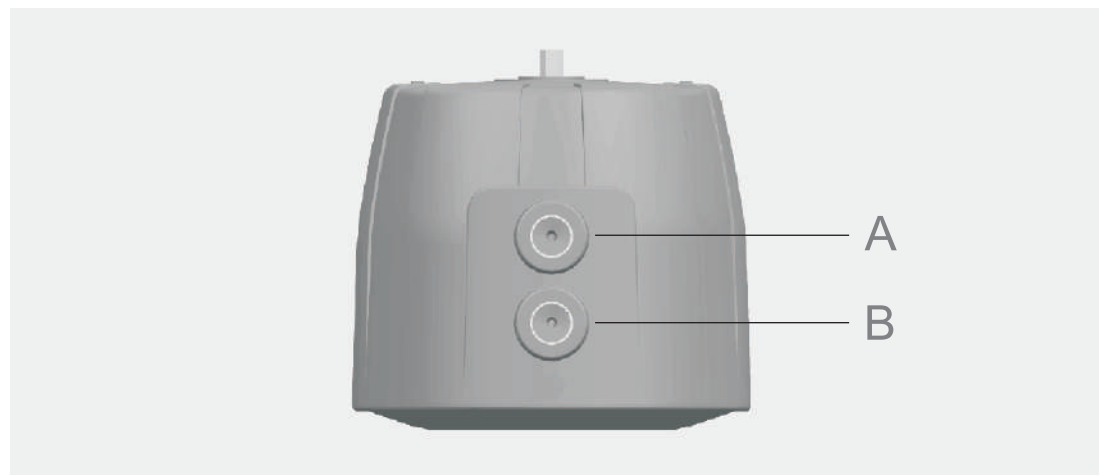

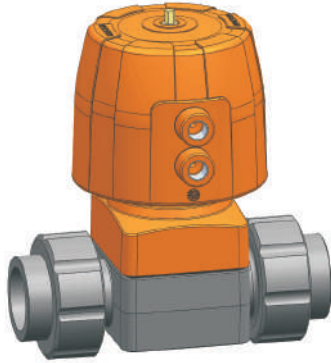

PVC-U 气动隔膜阀 NC
双由令/胶粘承插端 Union Socket-end
公制 DIN

<i>d</i> (mm)	<i>DN</i> (mm)	<i>PN</i> (bar)	<i>EPDM(per)</i>	<i>FPM(70)</i>	<i>EPDM-PTFE</i>	<i>KG</i>
20	15	6	302.022.1020	302.042.1020	302.062.1020	0,8
25	20	6	302.022.1025	302.042.1025	302.062.1025	1,0
32	25	6	302.022.1032	302.042.1032	302.062.1032	1,5
40	32	6	302.022.1040	302.042.1040	302.062.1040	2,3
50	40	6	302.022.1050	302.042.1050		3,6
63	50	6	302.022.1063	302.042.1063		3,9

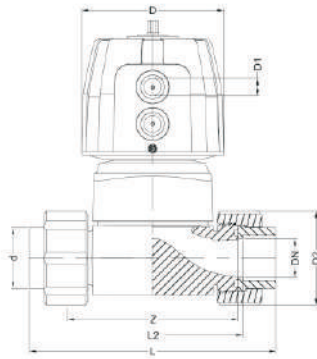

PVC-U 气动隔膜阀 NC
双由令/胶粘承插端 Union Socket-end
日标 JIS

<i>d</i> (mm)	<i>DN</i> (mm)	<i>PN</i> (bar)	<i>EPDM(per)</i>	<i>FPM(70)</i>	<i>EPDM-PTFE</i>	<i>KG</i>
20	15	6	302.022.1220	302.042.1220	302.062.1220	0,8
25	20	6	302.022.1225	302.042.1225	302.062.1225	1,0
32	25	6	302.022.1232	302.042.1232	302.062.1232	1,5
40	32	6	302.022.1240	302.042.1240	302.062.1240	2,3
50	40	6	302.022.1250	302.042.1250		3,6
63	50	6	302.022.1263	302.042.1263		3,9

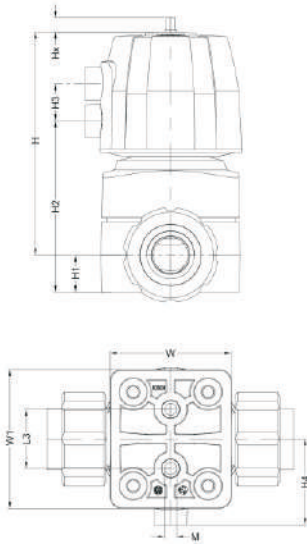

PVC-U 气动隔膜阀 NC
双由令/胶粘承插端 Union Socket-end
美标 ANSI

<i>d</i> (Inch)	<i>DN</i> (mm)	<i>PN</i> (bar)	<i>EPDM(per)</i>	<i>FPM(70)</i>	<i>EPDM-PTFE</i>	<i>KG</i>
1/2	15	6	302.022.1420	302.042.1420	302.062.1420	0,8
3/4	20	6	302.022.1425	302.042.1425	302.062.1425	1,0
1	25	6	302.022.1432	302.042.1432	302.062.1432	1,5
1-1/4	32	6	302.022.1440	302.042.1440	302.062.1440	2,3
1-1/2	40	6	302.022.1450	302.042.1450		3,6
2	50	6	302.022.1463	302.042.1463		3,9

Unit: mm

<i>d</i>	<i>DN</i>	<i>D</i>	<i>D1_G</i>	<i>D2</i>	<i>H</i>	<i>H1</i>	<i>H2</i>	<i>H3</i>	<i>H4</i>	<i>L</i>	<i>L3</i>	<i>M</i>	<i>Z</i>	<i>W</i>	<i>W1</i>	<i>Lift = Hx</i>
20	15	96	1/4	43	126	14	67	25	58	128	25	6	90	57	57	7
25	20	96	1/4	51	132	18	73	25	58	152	25	6	108	70	70	10
32	25	96	1/4	58	149	26	88	25	58	166	40	8	116	82	94	13
40	32	120	1/4	72	173	26	99	26	71	192	40	8	134	82	94	15
50	40	120	1/4	83	205	39	132	26	71	222	45	8	154	109	122	16
63	50	120	1/4	100	205	39	132	26	71	266	45	8	184	109	122	16

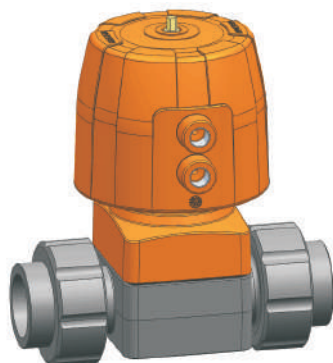

PVC-U 气动隔膜阀 NO
双由令/胶粘承插端 Union Socket-end
公制 DIN

<i>d</i> (mm)	<i>DN</i> (mm)	<i>PN</i> (bar)	<i>EPDM(per)</i>	<i>FPM(70)</i>	<i>EPDM-PTFE</i>	<i>KG</i>
20	15	6	302.024.1020	302.044.1020	302.064.1020	0,8
25	20	6	302.024.1025	302.044.1025	302.064.1025	1,0
32	25	6	302.024.1032	302.044.1032	302.064.1032	1,5
40	32	6	302.024.1040	302.044.1040	302.064.1040	2,2
50	40	6	302.024.1050	302.044.1050		3,3
63	50	6	302.024.1063	302.044.1063		3,7

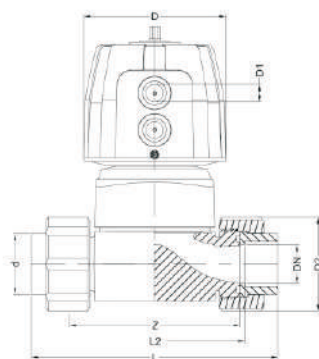

PVC-U 气动隔膜阀 NO
双由令/胶粘承插端 Union Socket-end
日标 JIS

<i>d</i> (mm)	<i>DN</i> (mm)	<i>PN</i> (bar)	<i>EPDM(per)</i>	<i>FPM(70)</i>	<i>EPDM-PTFE</i>	<i>KG</i>
20	15	6	302.024.1220	302.044.1220	302.064.1220	0,8
25	20	6	302.024.1225	302.044.1225	302.064.1225	1,0
32	25	6	302.024.1232	302.044.1232	302.064.1232	1,5
40	32	6	302.024.1240	302.044.1240	302.064.1240	2,2
50	40	6	302.024.1250	302.044.1250		3,3
63	50	6	302.024.1263	302.044.1263		3,7

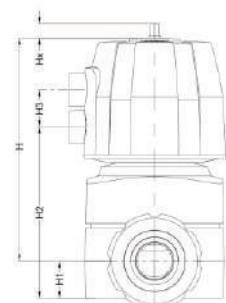

PVC-U 气动隔膜阀 NO
双由令/胶粘承插端 Union Socket-end
美标 ANSI

<i>d</i> (Inch)	<i>DN</i> (mm)	<i>PN</i> (bar)	<i>EPDM(per)</i>	<i>FPM(70)</i>	<i>EPDM-PTFE</i>	<i>KG</i>
1/2	15	6	302.024.1420	302.044.1420	302.064.1420	0,8
3/4	20	6	302.024.1425	302.044.1425	302.064.1425	1,0
1	25	6	302.024.1432	302.044.1432	302.064.1432	1,5
1-1/4	32	6	302.024.1440	302.044.1440	302.064.1440	2,2
1-1/2	40	6	302.024.1450	302.044.1450		3,3
2	50	6	302.024.1463	302.044.1463		3,7

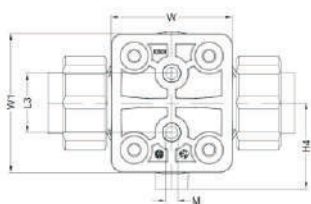

Unit: mm

<i>d</i>	<i>DN</i>	<i>D</i>	<i>D1_G</i>	<i>D2</i>	<i>H</i>	<i>H1</i>	<i>H2</i>	<i>H3</i>	<i>H4</i>	<i>L</i>	<i>L3</i>	<i>M</i>	<i>Z</i>	<i>W</i>	<i>W1</i>	<i>Lift = Hx</i>
20	15	96	1/4	43	126	14	67	25	58	128	25	6	90	57	57	7
25	20	96	1/4	51	132	18	73	25	58	152	25	6	108	70	70	10
32	25	96	1/4	58	149	26	88	25	58	166	40	8	116	82	94	13
40	32	120	1/4	72	173	26	99	26	71	192	40	8	134	82	94	15
50	40	120	1/4	83	205	39	132	26	71	222	45	8	154	109	122	16
63	50	120	1/4	100	205	39	132	26	71	266	45	8	184	109	122	16

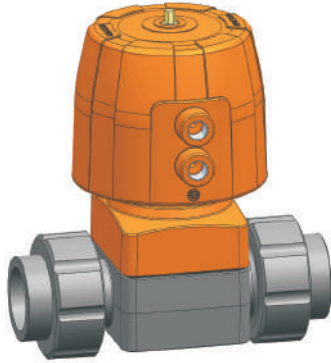

PVC-U 气动隔膜阀 DA
双由令/胶粘承插端 Union Socket-end
公制 DIN

<i>d</i> (mm)	<i>DN</i> (mm)	<i>PN</i> (bar)	<i>EPDM(per)</i>	<i>FPM(70)</i>	<i>EPDM-PTFE</i>	<i>KG</i>
20	15	6	302.026.1020	302.046.1020	302.066.1020	0,7
25	20	6	302.026.1025	302.046.1025	302.066.1025	0,9
32	25	6	302.026.1032	302.046.1032	302.066.1032	1,4
40	32	6	302.026.1040	302.046.1040	302.066.1040	2,0
50	40	6	302.026.1050	302.046.1050		3,2
63	50	6	302.026.1063	302.046.1063		3,5

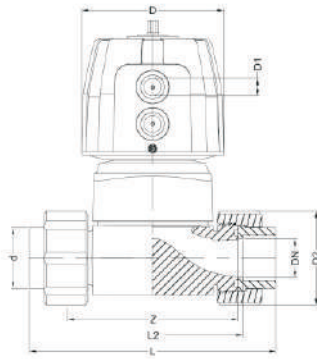

PVC-U 气动隔膜阀 DA
双由令/胶粘承插端 Union Socket-end
日标 JIS

<i>d</i> (mm)	<i>DN</i> (mm)	<i>PN</i> (bar)	<i>EPDM(per)</i>	<i>FPM(70)</i>	<i>EPDM-PTFE</i>	<i>KG</i>
20	15	6	302.026.1220	302.046.1220	302.066.1220	0,7
25	20	6	302.026.1225	302.046.1225	302.066.1225	0,9
32	25	6	302.026.1232	302.046.1232	302.066.1232	1,4
40	32	6	302.026.1240	302.046.1240	302.066.1240	2,0
50	40	6	302.026.1250	302.046.1250		3,2
63	50	6	302.026.1263	302.046.1263		3,5

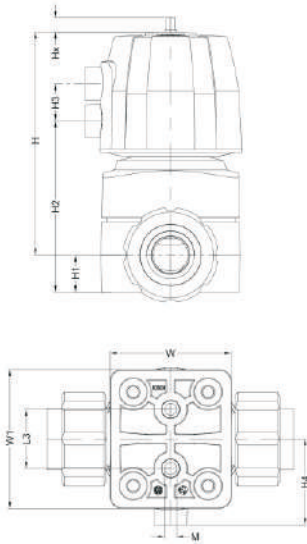

PVC-U 气动隔膜阀 DA
双由令/胶粘承插端 Union Socket-end
美标 ANSI

<i>d</i> (Inch)	<i>DN</i> (mm)	<i>PN</i> (bar)	<i>EPDM(per)</i>	<i>FPM(70)</i>	<i>EPDM-PTFE</i>	<i>KG</i>
1/2	15	6	302.026.1420	302.046.1420	302.066.1420	0,7
3/4	20	6	302.026.1425	302.046.1425	302.066.1425	0,9
1	25	6	302.026.1432	302.046.1432	302.066.1432	1,4
1-1/4	32	6	302.026.1440	302.046.1440	302.066.1440	2,0
1-1/2	40	6	302.026.1450	302.046.1450		3,2
2	50	6	302.026.1463	302.046.1463		3,5

Unit: mm

<i>d</i>	<i>DN</i>	<i>D</i>	<i>D1_G</i>	<i>D2</i>	<i>H</i>	<i>H1</i>	<i>H2</i>	<i>H3</i>	<i>H4</i>	<i>L</i>	<i>L3</i>	<i>M</i>	<i>Z</i>	<i>W</i>	<i>W1</i>	<i>Lift = Hx</i>
20	15	96	1/4	43	126	14	67	25	58	128	25	6	90	57	57	7
25	20	96	1/4	51	132	18	73	25	58	152	25	6	108	70	70	10
32	25	96	1/4	58	149	26	88	25	58	166	40	8	116	82	94	13
40	32	120	1/4	72	173	26	99	26	71	192	40	8	134	82	94	15
50	40	120	1/4	83	205	39	132	26	71	222	45	8	154	109	122	16
63	50	120	1/4	100	205	39	132	26	71	266	45	8	184	109	122	16

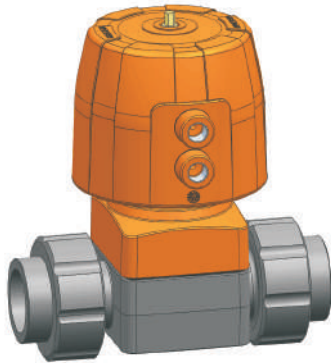

PVC-C 气动隔膜阀 NC
双由令/胶粘承插端 Union Socket-end
公制 DIN

<i>d</i> (mm)	<i>DN</i> (mm)	<i>PN</i> (bar)	<i>EPDM(per)</i>	<i>FPM(70)</i>	<i>EPDM-PTFE</i>	<i>KG</i>
20	15	6	302.222.1020	302.242.1020	302.262.1020	0,8
25	20	6	302.222.1025	302.242.1025	302.262.1025	1,0
32	25	6	302.222.1032	302.242.1032	302.262.1032	1,5
40	32	6	302.222.1040	302.242.1040	302.262.1040	2,3
50	40	6	302.222.1050	302.242.1050		3,6
63	50	6	302.222.1063	302.242.1063		3,9

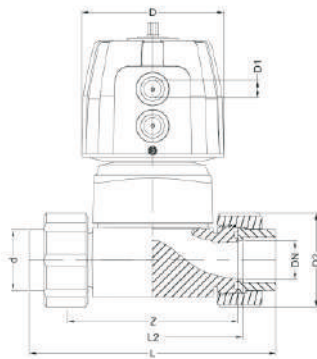

PVC-C 气动隔膜阀 NC
双由令/胶粘承插端 Union Socket-end
日标 JIS

<i>d</i> (mm)	<i>DN</i> (mm)	<i>PN</i> (bar)	<i>EPDM(per)</i>	<i>FPM(70)</i>	<i>EPDM-PTFE</i>	<i>KG</i>
20	15	6	302.222.1220	302.242.1220	302.262.1220	0,8
25	20	6	302.222.1225	302.242.1225	302.262.1225	1,0
32	25	6	302.222.1232	302.242.1232	302.262.1232	1,5
40	32	6	302.222.1240	302.242.1240	302.262.1240	2,3
50	40	6	302.222.1250	302.242.1250		3,6
63	50	6	302.222.1263	302.242.1263		3,9

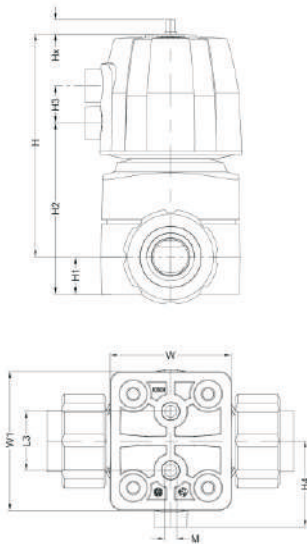

PVC-C 气动隔膜阀 NC
双由令/胶粘承插端 Union Socket-end
美标 ANSI

<i>d</i> (Inch)	<i>DN</i> (mm)	<i>PN</i> (bar)	<i>EPDM(per)</i>	<i>FPM(70)</i>	<i>EPDM-PTFE</i>	<i>KG</i>
1/2	15	6	302.222.1420	302.242.1420	302.262.1420	0,8
3/4	20	6	302.222.1425	302.242.1425	302.262.1425	1,0
1	25	6	302.222.1432	302.242.1432	302.262.1432	1,5
1-1/4	32	6	302.222.1440	302.242.1440	302.262.1440	2,3
1-1/2	40	6	302.222.1450	302.242.1450		3,6
2	50	6	302.222.1463	302.242.1463		3,9

Unit: mm

<i>d</i>	<i>DN</i>	<i>D</i>	<i>D1_G</i>	<i>D2</i>	<i>H</i>	<i>H1</i>	<i>H2</i>	<i>H3</i>	<i>H4</i>	<i>L</i>	<i>L3</i>	<i>M</i>	<i>Z</i>	<i>W</i>	<i>W1</i>	<i>Lift = Hx</i>
20	15	96	1/4	43	126	14	67	25	58	128	25	6	90	57	57	7
25	20	96	1/4	51	132	18	73	25	58	152	25	6	108	70	70	10
32	25	96	1/4	58	149	26	88	25	58	166	40	8	116	82	94	13
40	32	120	1/4	72	173	26	99	26	71	192	40	8	134	82	94	15
50	40	120	1/4	83	205	39	132	26	71	222	45	8	154	109	122	16
63	50	120	1/4	100	205	39	132	26	71	266	45	8	184	109	122	16

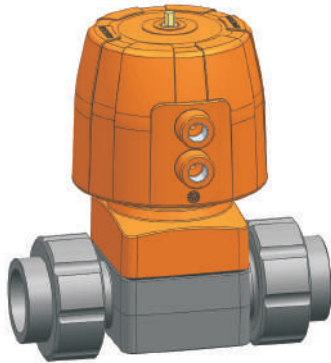

PVC-C 气动隔膜阀 NO
双由令/胶粘承插端 Union Socket-end
公制 DIN

<i>d</i> (mm)	<i>DN</i> (mm)	<i>PN</i> (bar)	<i>EPDM(per)</i>	<i>FPM(70)</i>	<i>EPDM-PTFE</i>	<i>KG</i>
20	15	6	302.224.1020	302.244.1020	302.264.1020	0,8
25	20	6	302.224.1025	302.244.1025	302.264.1025	1,0
32	25	6	302.224.1032	302.244.1032	302.264.1032	1,5
40	32	6	302.224.1040	302.244.1040	302.264.1040	2,2
50	40	6	302.224.1050	302.244.1050		3,3
63	50	6	302.224.1063	302.244.1063		3,7

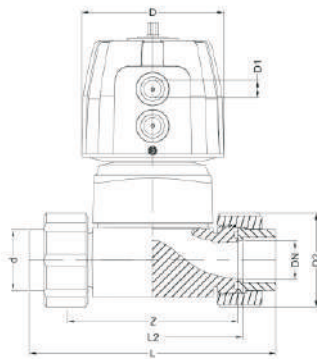

PVC-C 气动隔膜阀 NO
双由令/胶粘承插端 Union Socket-end
日标 JIS

<i>d</i> (mm)	<i>DN</i> (mm)	<i>PN</i> (bar)	<i>EPDM(per)</i>	<i>FPM(70)</i>	<i>EPDM-PTFE</i>	<i>KG</i>
20	15	6	302.224.1220	302.244.1220	302.264.1220	0,8
25	20	6	302.224.1225	302.244.1225	302.264.1225	1,0
32	25	6	302.224.1232	302.244.1232	302.264.1232	1,5
40	32	6	302.224.1240	302.244.1240	302.264.1240	2,2
50	40	6	302.224.1250	302.244.1250		3,3
63	50	6	302.224.1263	302.244.1263		3,7

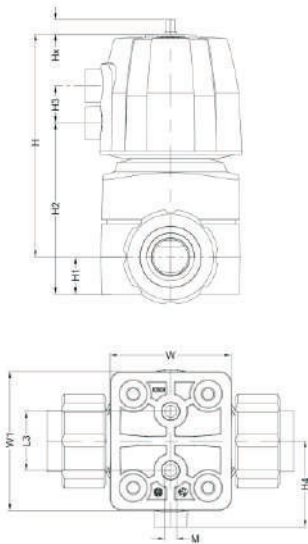

PVC-C 气动隔膜阀 NO
双由令/胶粘承插端 Union Socket-end
美标 ANSI

<i>d</i> (Inch)	<i>DN</i> (mm)	<i>PN</i> (bar)	<i>EPDM(per)</i>	<i>FPM(70)</i>	<i>EPDM-PTFE</i>	<i>KG</i>
1/2	15	6	302.224.1420	302.244.1420	302.264.1420	0,8
3/4	20	6	302.224.1425	302.244.1425	302.264.1425	1,0
1	25	6	302.224.1432	302.244.1432	302.264.1432	1,5
1-1/4	32	6	302.224.1440	302.244.1440	302.264.1440	2,2
1-1/2	40	6	302.224.1450	302.244.1450		3,3
2	50	6	302.224.1463	302.244.1463		3,7

Unit: mm

<i>d</i>	<i>DN</i>	<i>D</i>	<i>D1_G</i>	<i>D2</i>	<i>H</i>	<i>H1</i>	<i>H2</i>	<i>H3</i>	<i>H4</i>	<i>L</i>	<i>L3</i>	<i>M</i>	<i>Z</i>	<i>W</i>	<i>W1</i>	<i>Lift = Hx</i>
20	15	96	1/4	43	126	14	67	25	58	128	25	6	90	57	57	7
25	20	96	1/4	51	132	18	73	25	58	152	25	6	108	70	70	10
32	25	96	1/4	58	149	26	88	25	58	166	40	8	116	82	94	13
40	32	120	1/4	72	173	26	99	26	71	192	40	8	134	82	94	15
50	40	120	1/4	83	205	39	132	26	71	222	45	8	154	109	122	16
63	50	120	1/4	100	205	39	132	26	71	266	45	8	184	109	122	16

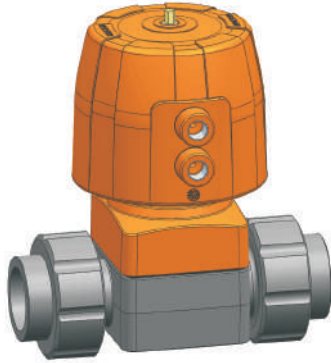

PVC-C 气动隔膜阀 DA
 双由令/胶粘承插端 Union Socket-end
 公制 DIN

<i>d</i> (mm)	<i>DN</i> (mm)	<i>PN</i> (bar)	<i>EPDM(per)</i>	<i>FPM(70)</i>	<i>EPDM-PTFE</i>	<i>KG</i>
20	15	6	302.226.1020	302.246.1020	302.266.1020	0,7
25	20	6	302.226.1025	302.246.1025	302.266.1025	0,9
32	25	6	302.226.1032	302.246.1032	302.266.1032	1,4
40	32	6	302.226.1040	302.246.1040	302.266.1040	2,0
50	40	6	302.226.1050	302.246.1050		3,2
63	50	6	302.226.1063	302.246.1063		3,5

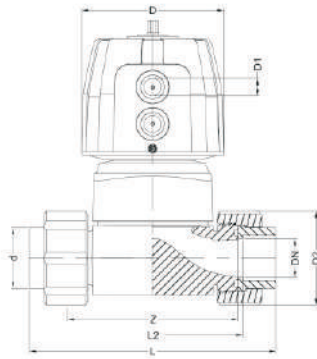

PVC-C 气动隔膜阀 DA
 双由令/胶粘承插端 Union Socket-end
 日标 JIS

<i>d</i> (mm)	<i>DN</i> (mm)	<i>PN</i> (bar)	<i>EPDM(per)</i>	<i>FPM(70)</i>	<i>EPDM-PTFE</i>	<i>KG</i>
20	15	6	302.226.1220	302.246.1220	302.266.1220	0,7
25	20	6	302.226.1225	302.246.1225	302.266.1225	0,9
32	25	6	302.226.1232	302.246.1232	302.266.1232	1,4
40	32	6	302.226.1240	302.246.1240	302.266.1240	2,0
50	40	6	302.226.1250	302.246.1250		3,2
63	50	6	302.226.1263	302.246.1263		3,5

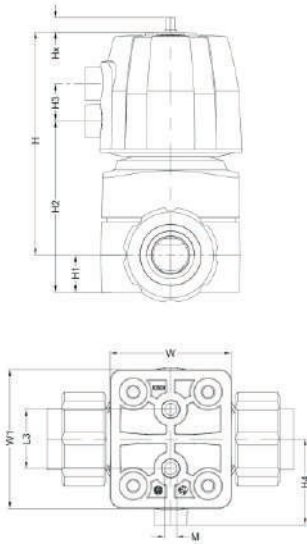

PVC-C 气动隔膜阀 DA
 双由令/胶粘承插端 Union Socket-end
 美标 ANSI

<i>d</i> (Inch)	<i>DN</i> (mm)	<i>PN</i> (bar)	<i>EPDM(per)</i>	<i>FPM(70)</i>	<i>EPDM-PTFE</i>	<i>KG</i>
1/2	15	6	302.226.1420	302.246.1420	302.266.1420	0,7
3/4	20	6	302.226.1425	302.246.1425	302.266.1425	0,9
1	25	6	302.226.1432	302.246.1432	302.266.1432	1,4
1-1/4	32	6	302.226.1440	302.246.1440	302.266.1440	2,0
1-1/2	40	6	302.226.1450	302.246.1450		3,2
2	50	6	302.226.1463	302.246.1463		3,5

Unit: mm

<i>d</i>	<i>DN</i>	<i>D</i>	<i>D1_G</i>	<i>D2</i>	<i>H</i>	<i>H1</i>	<i>H2</i>	<i>H3</i>	<i>H4</i>	<i>L</i>	<i>L3</i>	<i>M</i>	<i>Z</i>	<i>W</i>	<i>W1</i>	<i>Lift = Hx</i>
20	15	96	1/4	43	126	14	67	25	58	128	25	6	90	57	57	7
25	20	96	1/4	51	132	18	73	25	58	152	25	6	108	70	70	10
32	25	96	1/4	58	149	26	88	25	58	166	40	8	116	82	94	13
40	32	120	1/4	72	173	26	99	26	71	192	40	8	134	82	94	15
50	40	120	1/4	83	205	39	132	26	71	222	45	8	154	109	122	16
63	50	120	1/4	100	205	39	132	26	71	266	45	8	184	109	122	16

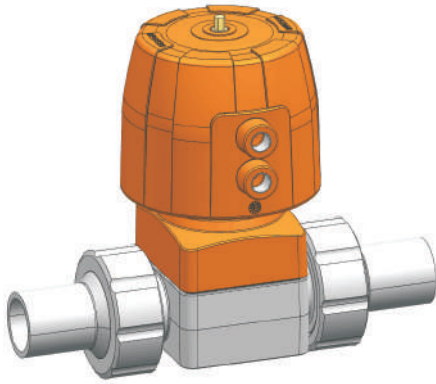

PP-H 气动隔膜阀 NC
 双由令/热熔承插端 Union Socket-end
 公制 DIN

<i>d</i> (mm)	<i>DN</i> (mm)	<i>PN</i> (bar)	<i>EPDM(per)</i>	<i>FPM(70)</i>	<i>EPDM-PTFE</i>	<i>KG</i>
20	15	6	302.422.1020	302.442.1020	302.462.1020	0,8
25	20	6	302.422.1025	302.442.1025	302.462.1025	1,0
32	25	6	302.422.1032	302.442.1032	302.462.1032	1,4
40	32	6	302.422.1040	302.442.1040	302.462.1040	2,2
50	40	6	302.422.1050	302.442.1050		3,3
63	50	6	302.422.1063	302.442.1063		3,6

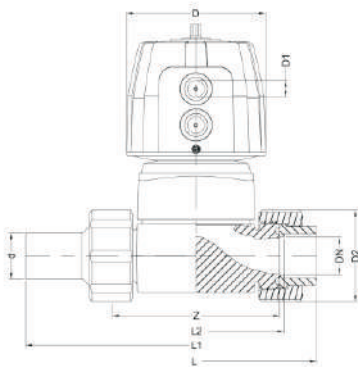

PP-H 气动隔膜阀 NC
 双由令/对焊接端 Union Spigot Butt+IR
 公制 DIN

<i>d</i> (mm)	<i>DN</i> (mm)	<i>PN</i> (bar)	<i>EPDM(per)</i>	<i>FPM(70)</i>	<i>EPDM-PTFE</i>	<i>KG</i>
20	15	6	302.422.3020	302.442.3020	302.462.3020	0,8
25	20	6	302.422.3025	302.442.3025	302.462.3025	1,0
32	25	6	302.422.3032	302.442.3032	302.462.3032	1,4
40	32	6	302.422.3040	302.442.3040	302.462.3040	2,2
50	40	6	302.422.3050	302.442.3050		3,3
63	50	6	302.422.3063	302.442.3063		3,6

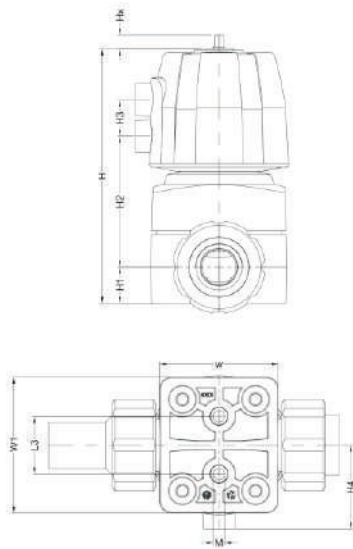

PP-H 气动禁油隔膜阀 NC
 双由令/对焊接端 Union Spigot Butt+IR , Oil-free
 公制 DIN

<i>d</i> (mm)	<i>DN</i> (mm)	<i>PN</i> (bar)	<i>EPDM-PTFE</i>	<i>KG</i>
20	15	6	302.462.3020.N	0,8
25	20	6	302.462.3025.N	1,0
32	25	6	302.462.3032.N	1,4
40	32	6	302.462.3040.N	2,2
50	40	6		
63	50	6		

Unit: mm

<i>d</i>	<i>DN</i>	<i>D</i>	<i>D1_G</i>	<i>D2</i>	<i>H</i>	<i>H1</i>	<i>H2</i>	<i>H3</i>	<i>H4</i>	<i>L</i>	<i>L1</i>	<i>L3</i>	<i>M</i>	<i>Z</i>	<i>W</i>	<i>W1</i>	<i>Lift = Hx</i>
20	15	96	1/4	43	126	14	67	25	58	128	196	25	6	90	57	57	7
25	20	96	1/4	51	132	18	73	25	58	152	221	25	6	108	70	70	10
32	25	96	1/4	58	149	26	88	25	58	166	234	40	8	116	82	94	13
40	32	120	1/4	72	173	26	99	26	71	192	260	40	8	134	82	94	15
50	40	120	1/4	83	205	39	132	26	71	222	284	45	8	154	109	122	16
63	50	120	1/4	100	205	39	132	26	71	266	321	45	8	184	109	122	16

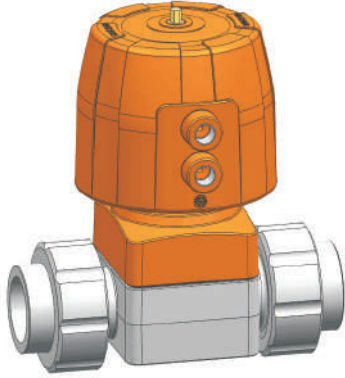

PP-H 气动隔膜阀 NO
 双由令/热熔承插端 Union Socket-end
 公制 DIN

<i>d</i> (mm)	<i>DN</i> (mm)	<i>PN</i> (bar)	<i>EPDM(per)</i>	<i>FPM(70)</i>	<i>EPDM-PTFE</i>	<i>KG</i>
20	15	6	302.424.1020	302.444.1020	302.464.1020	0,8
25	20	6	302.424.1025	302.444.1025	302.464.1025	0,9
32	25	6	302.424.1032	302.444.1032	302.464.1032	1,4
40	32	6	302.424.1040	302.444.1040	302.464.1040	2,1
50	40	6	302.424.1050	302.444.1050		3,0
63	50	6	302.424.1063	302.444.1063		3,3

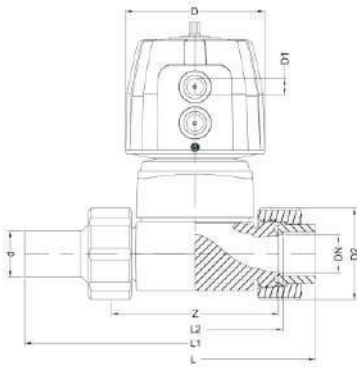

PP-H 气动隔膜阀 NO
 双由令/对焊接端 Union Spigot Butt+IR
 公制 DIN

<i>d</i> (mm)	<i>DN</i> (mm)	<i>PN</i> (bar)	<i>EPDM(per)</i>	<i>FPM(70)</i>	<i>EPDM-PTFE</i>	<i>KG</i>
20	15	6	302.424.3020	302.444.3020	302.464.3020	0,8
25	20	6	302.424.3025	302.444.3025	302.464.3025	0,9
32	25	6	302.424.3032	302.444.3032	302.464.3032	1,4
40	32	6	302.424.3040	302.444.3040	302.464.3040	2,1
50	40	6	302.424.3050	302.444.3050		3,0
63	50	6	302.424.3063	302.444.3063		3,3

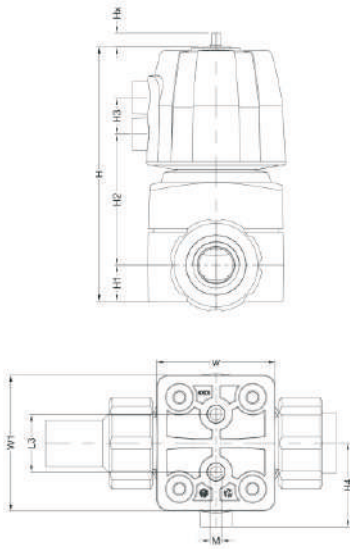

PP-H 气动禁油隔膜阀 NO
 双由令/对焊接端 Union Spigot Butt+IR , Oil-free
 公制 DIN

<i>d</i> (mm)	<i>DN</i> (mm)	<i>PN</i> (bar)	<i>EPDM-PTFE</i>	<i>KG</i>
20	15	6	302.464.3020.N	0,8
25	20	6	302.464.3025.N	0,9
32	25	6	302.464.3032.N	1,4
40	32	6	302.464.3040.N	2,1
50	40	6		
63	50	6		

Unit: mm

<i>d</i>	<i>DN</i>	<i>D</i>	<i>D1_G</i>	<i>D2</i>	<i>H</i>	<i>H1</i>	<i>H2</i>	<i>H3</i>	<i>H4</i>	<i>L</i>	<i>L1</i>	<i>L3</i>	<i>M</i>	<i>Z</i>	<i>W</i>	<i>W1</i>	<i>Lift = Hx</i>
20	15	96	1/4	43	126	14	67	25	58	128	196	25	6	90	57	57	7
25	20	96	1/4	51	132	18	73	25	58	152	221	25	6	108	70	70	10
32	25	96	1/4	58	149	26	88	25	58	166	234	40	8	116	82	94	13
40	32	120	1/4	72	173	26	99	26	71	192	260	40	8	134	82	94	15
50	40	120	1/4	83	205	39	132	26	71	222	284	45	8	154	109	122	16
63	50	120	1/4	100	205	39	132	26	71	266	321	45	8	184	109	122	16

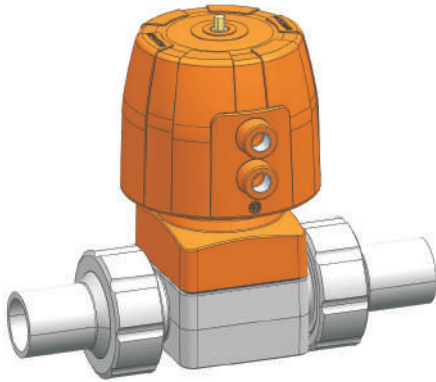

PP-H 气动隔膜阀 DA
 双由令/热熔承插端 Union Socket-end
 公制 DIN

<i>d</i> (mm)	<i>DN</i> (mm)	<i>PN</i> (bar)	<i>EPDM(per)</i>	<i>FPM(70)</i>	<i>EPDM-PTFE</i>	<i>KG</i>
20	15	6	302.426.1020	302.446.1020	302.466.1020	0,7
25	20	6	302.426.1025	302.446.1025	302.466.1025	0,9
32	25	6	302.426.1032	302.446.1032	302.466.1032	1,3
40	32	6	302.426.1040	302.446.1040	302.466.1040	1,9
50	40	6	302.426.1050	302.446.1050		2,9
63	50	6	302.426.1063	302.446.1063		3,2

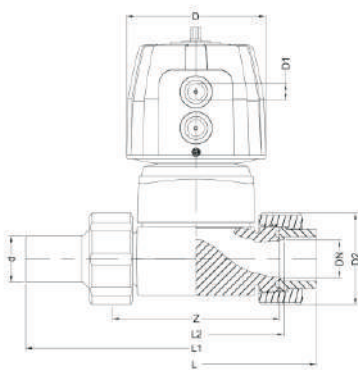

PP-H 气动隔膜阀 DA
 双由令/对焊接端 Union Spigot Butt+IR
 公制 DIN

<i>d</i> (mm)	<i>DN</i> (mm)	<i>PN</i> (bar)	<i>EPDM(per)</i>	<i>FPM(70)</i>	<i>EPDM-PTFE</i>	<i>KG</i>
20	15	6	302.426.3020	302.446.3020	302.466.3020	0,7
25	20	6	302.426.3025	302.446.3025	302.466.3025	0,9
32	25	6	302.426.3032	302.446.3032	302.466.3032	1,3
40	32	6	302.426.3040	302.446.3040	302.466.3040	1,9
50	40	6	302.426.3050	302.446.3050		2,9
63	50	6	302.426.3063	302.446.3063		3,2

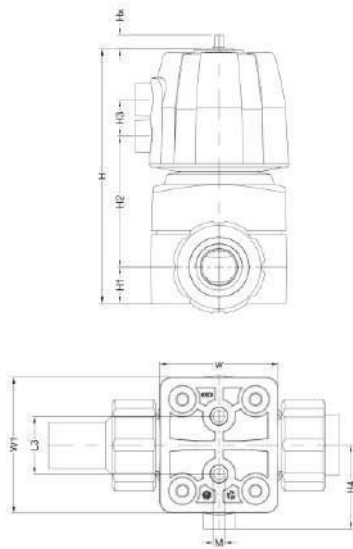

PP-H 气动禁油隔膜阀 DA
 双由令/对焊接端 Union Spigot Butt+IR , Oil-free
 公制 DIN

<i>d</i> (mm)	<i>DN</i> (mm)	<i>PN</i> (bar)	<i>EPDM-PTFE</i>	<i>KG</i>
20	15	6	302.466.3020.N	0,7
25	20	6	302.466.3025.N	0,9
32	25	6	302.466.3032.N	1,3
40	32	6	302.466.3040.N	1,9
50	40	6		
63	50	6		

Unit: mm

<i>d</i>	<i>DN</i>	<i>D</i>	<i>D1_G</i>	<i>D2</i>	<i>H</i>	<i>H1</i>	<i>H2</i>	<i>H3</i>	<i>H4</i>	<i>L</i>	<i>L1</i>	<i>L3</i>	<i>M</i>	<i>Z</i>	<i>W</i>	<i>W1</i>	<i>Lift = Hx</i>
20	15	96	1/4	43	126	14	67	25	58	128	196	25	6	90	57	57	7
25	20	96	1/4	51	132	18	73	25	58	152	221	25	6	108	70	70	10
32	25	96	1/4	58	149	26	88	25	58	166	234	40	8	116	82	94	13
40	32	120	1/4	72	173	26	99	26	71	192	260	40	8	134	82	94	15
50	40	120	1/4	83	205	39	132	26	71	222	284	45	8	154	109	122	16
63	50	120	1/4	100	205	39	132	26	71	266	321	45	8	184	109	122	16

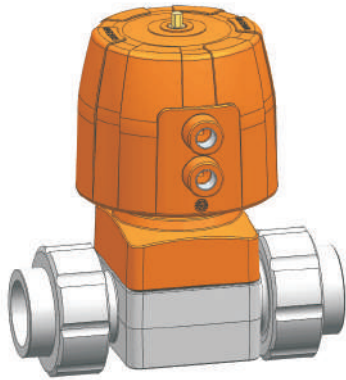

PP-N 气动隔膜阀 NC
 双由令/热熔承插端 Union Socket-end
 公制 DIN

<i>d</i> (mm)	<i>DN</i> (mm)	<i>PN</i> (bar)	<i>EPDM(per)</i>	<i>FPM(70)</i>	<i>EPDM-PTFE</i>	<i>KG</i>
20	15	6	302.522.1020	302.542.1020	302.562.1020	0,8
25	20	6	302.522.1025	302.542.1025	302.562.1025	1,0
32	25	6	302.522.1032	302.542.1032	302.562.1032	1,4
40	32	6	302.522.1040	302.542.1040	302.562.1040	2,2
50	40	6	302.522.1050	302.542.1050		3,3
63	50	6	302.522.1063	302.542.1063		3,6

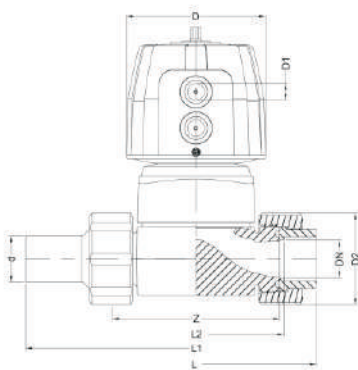

PP-N 气动隔膜阀 NC
 双由令/对焊接端 Union Spigot Butt+IR
 公制 DIN

<i>d</i> (mm)	<i>DN</i> (mm)	<i>PN</i> (bar)	<i>EPDM(per)</i>	<i>FPM(70)</i>	<i>EPDM-PTFE</i>	<i>KG</i>
20	15	6	302.522.3020	302.542.3020	302.562.3020	0,8
25	20	6	302.522.3025	302.542.3025	302.562.3025	1,0
32	25	6	302.522.3032	302.542.3032	302.562.3032	1,4
40	32	6	302.522.3040	302.542.3040	302.562.3040	2,2
50	40	6	302.522.3050	302.542.3050		3,3
63	50	6	302.522.3063	302.542.3063		3,6

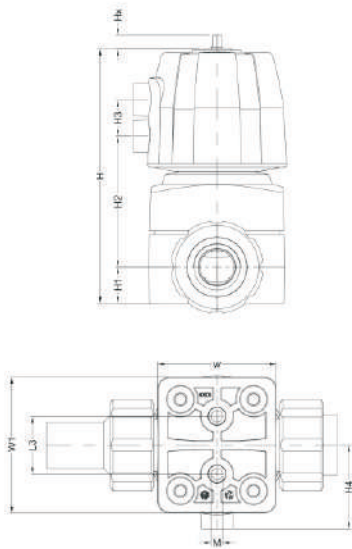

PP-N 气动禁油隔膜阀 NC
 双由令/对焊接端 Union Spigot Butt+IR , Oil-free
 公制 DIN

<i>d</i> (mm)	<i>DN</i> (mm)	<i>PN</i> (bar)	<i>EPDM-PTFE</i>	<i>KG</i>
20	15	6	302.562.3020.N	0,8
25	20	6	302.562.3025.N	1,0
32	25	6	302.562.3032.N	1,4
40	32	6	302.562.3040.N	2,2
50	40	6		
63	50	6		

Unit: mm

<i>d</i>	<i>DN</i>	<i>D</i>	<i>D1_G</i>	<i>D2</i>	<i>H</i>	<i>H1</i>	<i>H2</i>	<i>H3</i>	<i>H4</i>	<i>L</i>	<i>L1</i>	<i>L3</i>	<i>M</i>	<i>Z</i>	<i>W</i>	<i>W1</i>	<i>Lift = Hx</i>
20	15	96	1/4	43	126	14	67	25	58	128	196	25	6	90	57	57	7
25	20	96	1/4	51	132	18	73	25	58	152	221	25	6	108	70	70	10
32	25	96	1/4	58	149	26	88	25	58	166	234	40	8	116	82	94	13
40	32	120	1/4	72	173	26	99	26	71	192	260	40	8	134	82	94	15
50	40	120	1/4	83	205	39	132	26	71	222	284	45	8	154	109	122	16
63	50	120	1/4	100	205	39	132	26	71	266	321	45	8	184	109	122	16

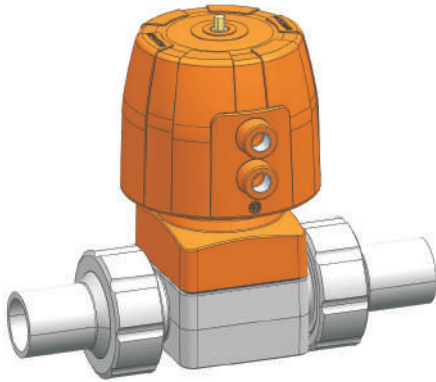

PVDF 气动隔膜阀 NC
双由令/热熔承插端 Union Socket-end
公制 DIN

<i>d</i> (mm)	<i>DN</i> (mm)	<i>PN</i> (bar)	<i>FPM(70)</i>	<i>EPDM-PTFE</i>	<i>KG</i>
20	15	6	302.642.1020	302.662.1020	0,9
25	20	6	302.642.1025	302.662.1025	1,1
32	25	6	302.642.1032	302.662.1032	1,7
40	32	6	302.642.1040	302.662.1040	2,5
50	40	6	302.642.1050		3,9
63	50	6	302.642.1063		4,3

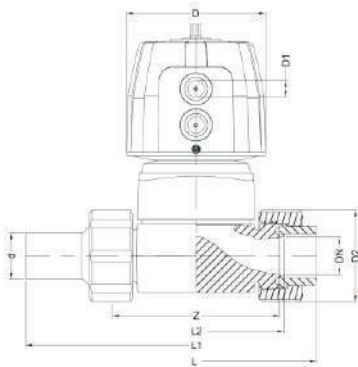

PVDF 气动隔膜阀 NC
双由令/对焊接端 Union Spigot Butt+IR
公制 DIN

<i>d</i> (mm)	<i>DN</i> (mm)	<i>PN</i> (bar)	<i>FPM(70)</i>	<i>EPDM-PTFE</i>	<i>KG</i>
20	15	6	302.642.3020	302.662.3020	0,9
25	20	6	302.642.3025	302.662.3025	1,1
32	25	6	302.642.3032	302.662.3032	1,7
40	32	6	302.642.3040	302.662.3040	2,5
50	40	6	302.642.3050		3,9
63	50	6	302.642.3063		4,3

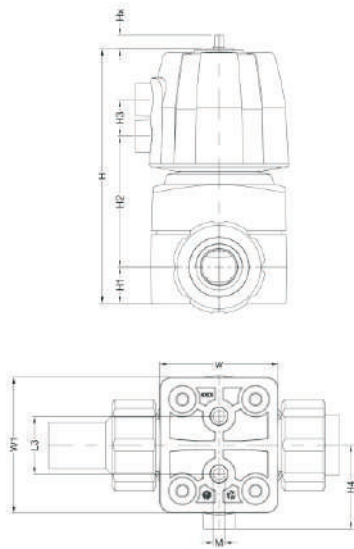

PVDF 气动禁油隔膜阀 NC
双由令/对焊接端 Union Spigot Butt+IR , Oil-free
公制 DIN

<i>d</i> (mm)	<i>DN</i> (mm)	<i>PN</i> (bar)	<i>EPDM-PTFE</i>	<i>KG</i>
20	15	6	302.662.3020.N	0,9
25	20	6	302.662.3025.N	1,1
32	25	6	302.662.3032.N	1,7
40	32	6	302.662.3040.N	2,5
50	40	6		
63	50	6		

Unit: mm

<i>d</i>	<i>DN</i>	<i>D</i>	<i>D1_G</i>	<i>D2</i>	<i>H</i>	<i>H1</i>	<i>H2</i>	<i>H3</i>	<i>H4</i>	<i>L</i>	<i>L1</i>	<i>L3</i>	<i>M</i>	<i>Z</i>	<i>W</i>	<i>W1</i>	<i>Lift = Hx</i>
20	15	96	1/4	43	126	14	67	25	58	128	196	25	6	90	57	57	7
25	20	96	1/4	51	132	18	73	25	58	152	221	25	6	108	70	70	10
32	25	96	1/4	58	149	26	88	25	58	166	234	40	8	116	82	94	13
40	32	120	1/4	72	173	26	99	26	71	192	260	40	8	134	82	94	15
50	40	120	1/4	83	205	39	132	26	71	222	284	45	8	154	109	122	16
63	50	120	1/4	100	205	39	132	26	71	266	321	45	8	184	109	122	16

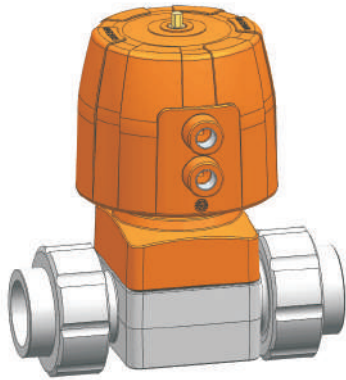

PVDF 气动隔膜阀 NO
双由令/热熔承插端 Union Socket-end
公制 DIN

<i>d</i> (mm)	<i>DN</i> (mm)	<i>PN</i> (bar)	<i>FPM(70)</i>	<i>EPDM-PTFE</i>	<i>KG</i>
20	15	6	302.644.1020	302.664.1020	0,9
25	20	6	302.644.1025	302.664.1025	1,1
32	25	6	302.644.1032	302.664.1032	1,6
40	32	6	302.644.1040	302.664.1040	2,4
50	40	6	302.644.1050		3,7
63	50	6	302.644.1063		4,1

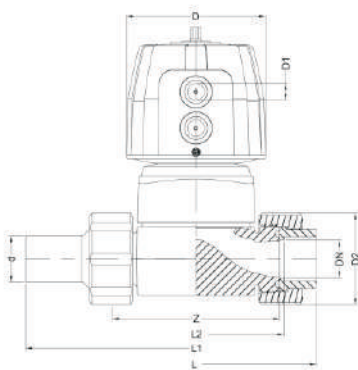

PVDF 气动隔膜阀 NO
双由令/对焊接端 Union Spigot Butt+IR
公制 DIN

<i>d</i> (mm)	<i>DN</i> (mm)	<i>PN</i> (bar)	<i>FPM(70)</i>	<i>EPDM-PTFE</i>	<i>KG</i>
20	15	6	302.644.3020	302.664.3020	0,9
25	20	6	302.644.3025	302.664.3025	1,1
32	25	6	302.644.3032	302.664.3032	1,6
40	32	6	302.644.3040	302.664.3040	2,4
50	40	6	302.644.3050		3,7
63	50	6	302.644.3063		4,1

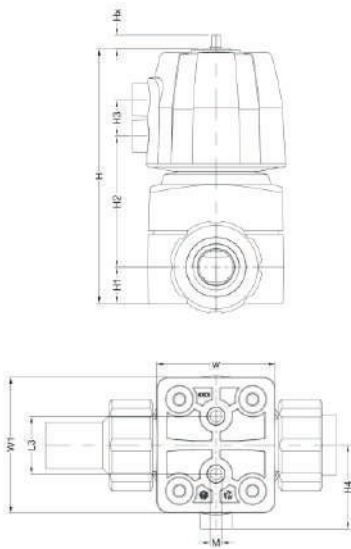

PVDF 气动禁油隔膜阀 NO
双由令/对焊接端 Union Spigot Butt+IR , Oil-free
公制 DIN

<i>d</i> (mm)	<i>DN</i> (mm)	<i>PN</i> (bar)	<i>EPDM-PTFE</i>	<i>KG</i>
20	15	6	302.664.3020.N	0,9
25	20	6	302.664.3025.N	1,1
32	25	6	302.664.3032.N	1,6
40	32	6	302.664.3040.N	2,4
50	40	6		
63	50	6		

Unit: mm

<i>d</i>	<i>DN</i>	<i>D</i>	<i>D1_G</i>	<i>D2</i>	<i>H</i>	<i>H1</i>	<i>H2</i>	<i>H3</i>	<i>H4</i>	<i>L</i>	<i>L1</i>	<i>L3</i>	<i>M</i>	<i>Z</i>	<i>W</i>	<i>W1</i>	<i>Lift = Hx</i>
20	15	96	1/4	43	126	14	67	25	58	128	196	25	6	90	57	57	7
25	20	96	1/4	51	132	18	73	25	58	152	221	25	6	108	70	70	10
32	25	96	1/4	58	149	26	88	25	58	166	234	40	8	116	82	94	13
40	32	120	1/4	72	173	26	99	26	71	192	260	40	8	134	82	94	15
50	40	120	1/4	83	205	39	132	26	71	222	284	45	8	154	109	122	16
63	50	120	1/4	100	205	39	132	26	71	266	321	45	8	184	109	122	16

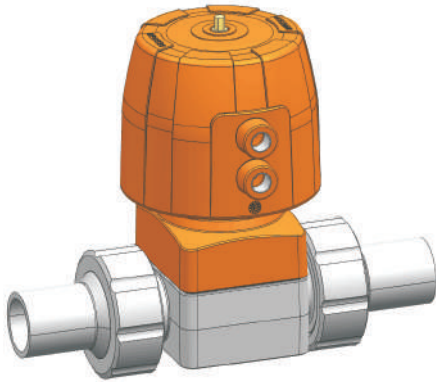

PVDF 气动隔膜阀 DA
双由令/热熔承插端 Union Socket-end
公制 DIN

<i>d</i> (mm)	<i>DN</i> (mm)	<i>PN</i> (bar)	<i>FPM(70)</i>	<i>EPDM-PTFE</i>	<i>KG</i>
20	15	6	302.646.1020	302.666.1020	0,8
25	20	6	302.646.1025	302.666.1025	1,0
32	25	6	302.646.1032	302.666.1032	1,6
40	32	6	302.646.1040	302.666.1040	2,3
50	40	6	302.646.1050		3,5
63	50	6	302.646.1063		3,9

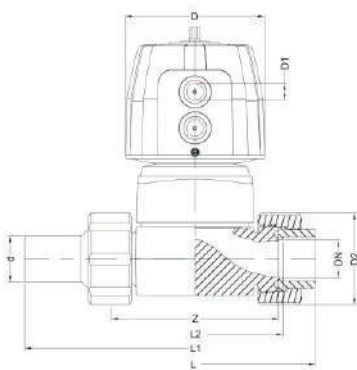

PVDF 气动隔膜阀 DA
双由令/对焊接端 Union Spigot Butt+IR
公制 DIN

<i>d</i> (mm)	<i>DN</i> (mm)	<i>PN</i> (bar)	<i>FPM(70)</i>	<i>EPDM-PTFE</i>	<i>KG</i>
20	15	6	302.646.3020	302.666.3020	0,8
25	20	6	302.646.3025	302.666.3025	1,0
32	25	6	302.646.3032	302.666.3032	1,6
40	32	6	302.646.3040	302.666.3040	2,3
50	40	6	302.646.3050		3,5
63	50	6	302.646.3063		3,9

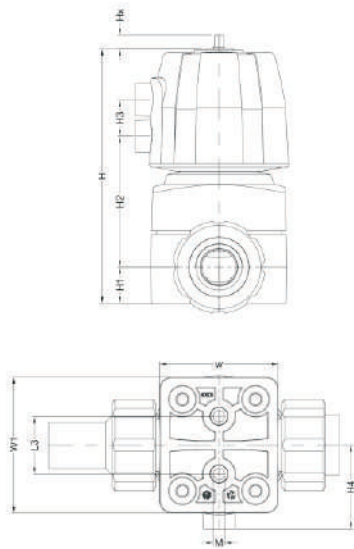

PVDF 气动禁油隔膜阀 DA
双由令/对焊接端 Union Spigot Butt+IR , Oil-free
公制 DIN

<i>d</i> (mm)	<i>DN</i> (mm)	<i>PN</i> (bar)	<i>EPDM-PTFE</i>	<i>KG</i>
20	15	6	302.666.3020.N	0,8
25	20	6	302.666.3025.N	1,0
32	25	6	302.666.3032.N	1,6
40	32	6	302.666.3040.N	2,3
50	40	6		
63	50	6		

Unit: mm

<i>d</i>	<i>DN</i>	<i>D</i>	<i>D1_G</i>	<i>D2</i>	<i>H</i>	<i>H1</i>	<i>H2</i>	<i>H3</i>	<i>H4</i>	<i>L</i>	<i>L1</i>	<i>L3</i>	<i>M</i>	<i>Z</i>	<i>W</i>	<i>W1</i>	<i>Lift = Hx</i>
20	15	96	1/4	43	126	14	67	25	58	128	196	25	6	90	57	57	7
25	20	96	1/4	51	132	18	73	25	58	152	221	25	6	108	70	70	10
32	25	96	1/4	58	149	26	88	25	58	166	234	40	8	116	82	94	13
40	32	120	1/4	72	173	26	99	26	71	192	260	40	8	134	82	94	15
50	40	120	1/4	83	205	39	132	26	71	222	284	45	8	154	109	122	16
63	50	120	1/4	100	205	39	132	26	71	266	321	45	8	184	109	122	16

**ontact**
customer center
www.koscn.cn



KOSCN